



2N® LTE Verso

2N® LTE Verso combines minimum installation costs with a full feature set. Using LTE technology means no other cable apart from a power supply is needed, with a benefit of all advanced functionalities such as a video communication. The main unit with HD camera can be accompanied by RFID, Bluetooth or biometrics supporting modules.



Villas
Small office-home office

Family houses
Office building

Ideal retrofit solution

Thanks to LTE connection 2N® LTE Verso is not depending on available wiring and answering units. Together with 2N® Mobile Video service it offers full range of features like video calls to mobile devices and 2N answering units just like wired intercom.

Secure configuration via cloud

Connect 2N® LTE Verso to the LTE network and then use 2N® Mobile Video service on My2N.com to configure all its features from anywhere in the world via secured VPN connection.

Pick any of the 14 modules available

2N® LTE Verso is using a standard BUS and therefore it can be connected to any of the additional modules, e.g. RFID, Bluetooth or biometrics. Choose a module with technology that suits you the most.

2N® LTE Verso

FEATURES & BENEFITS

MINIMUM INSTALLATION COSTS

The LTE intercom doesn't need any cables and therefore it's an ideal solution for retrofit in older buildings where addition wiring installation would be uneconomical.

MODULARITY

The modularity of this IP intercom allows you to configure it to your requirements. Select the specific module, accessories and configurable functions.

MOBILE CREDENTIALS ARE FOR FREE

Unlike our competitors, 2N offers mobile credentials via Bluetooth for free. Don't pay 6-10USD per each credential or any other fees. Simply install 2N® Mobile Key app and start to use your phone to open the door!

CALLS TO MOBILE PHONE AND TABLET

2N® LTE Verso allows you to call a mobile phone or tablet over the cellular data in case, that even these mobile devices are connected to the Internet.

CAMERA WITH NIGHT VISION

See who is standing in front of your door, even in total darkness. Moreover, the camera is hidden from normal view. The intruder has no clue they're being monitored.

SIP SUPPORT WITH NO SERVER NEEDED

SIP protocol support makes it easy to link the intercom with IP phones and PBX from other producers, without having to connect to the server.

PICTURE TO EMAIL

2N® LTE Verso allows you to email snapshots of the visitor captured by the camera at the time of the call..

ACCESS CONTROL

Achieve a greater level of security for all those at its location. 2N® LTE Verso makes it easy to prevent the entry of unauthorized persons.

DIAGRAM

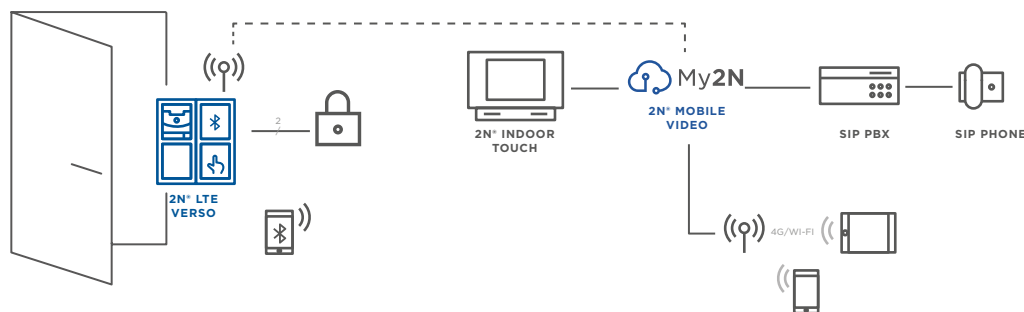

TECHNICAL PARAMETERS

Signalling protocol

SIP 2.0 (RFC - 3261)

Buttons

| | |
|-------------------|---|
| Buttons | Transparent buttons with white backlight and easily removable label |
| Number of buttons | 1 to 146 |
| Numeric keypad | Optional |

Audio

| | |
|---|-----------------------|
| Microphone | 1 built-in microphone |
| Speaker | 2W |
| Sound pressure at 1 kHz at 1 m distance | 78 dB |

Audio stream

| | |
|--------|--------------------------------|
| Codecs | G.711, G.729, G.722, L16/16kHz |
|--------|--------------------------------|

Camera (optional)

| | |
|-------------------------|-----------------------------|
| Resolution - JPEG | 1280 x 960 px |
| Resolution - video call | 640 x 480 px |
| Viewing angle | 120° (H), 90° (V), 145° (D) |
| Night vision | Yes |

Video stream

| | |
|--------|-------------------------------------|
| Codecs | H.263+, H.263, H.264, MJPEG, MPEG-4 |
|--------|-------------------------------------|

Interfaces

| | |
|----------------------|--|
| Power supply | 12V ± 15% / 2A DC |
| Network connection | LTE FDD Cat.1, 3GPP release 9 compliant 4G Bands (MHz): B1(2100), B3(1800), B7(2600), B8(900), B20(800) Output power - Class 3 (0.2 W, 23 dBm) @ LTE |
| Switch output | NC/NO contacts, max 30 V/1 A AC/DC |
| Connection speed | Uplink up to 5 Mbps Downlink up to 10 Mbps |
| Active switch output | 8 to 12 V DC depending on power supply (source voltage minus 2 V), max 400mA |

Mechanical properties

| | |
|-----------------------------|--|
| Operating temperature | -40°C - 60°C, touch display -30°C - 60°C |
| Storage temperature | -40°C - 70°C |
| Operating relative humidity | 10%-95% (non-condensing) |
| Coverage level | IP 54, IK08, touch display IK07 |

Dimensions

Dimensions depend on configuration of the modules and installation type - see www.2n.cz for details.

SOFTWARE

2N® Mobile Key - an application that turns your mobile phone into an access card

2N® Mobile Video - mobile application providing video calls from the intercom to your mobile device

Modularity

MODULARITY CLARIFIED

2N® LTE Verso can be tailored to your requirements. Select the specific modules, frame and mounting box.

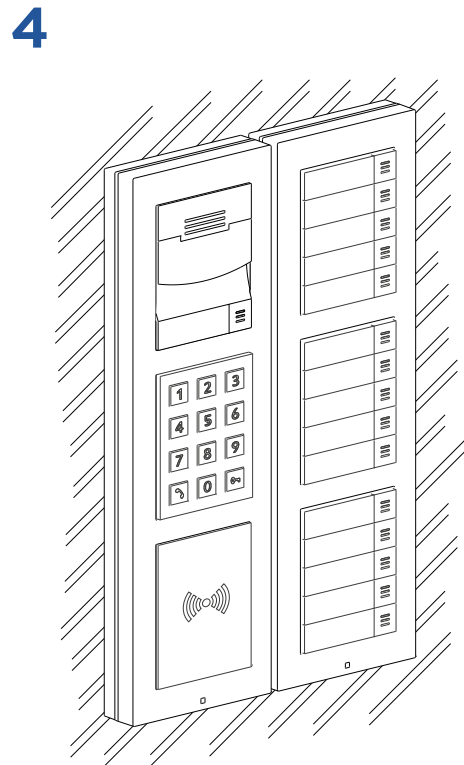
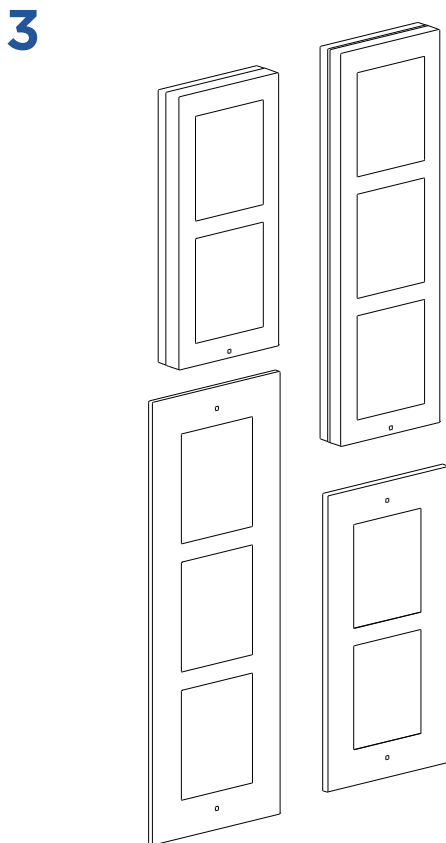
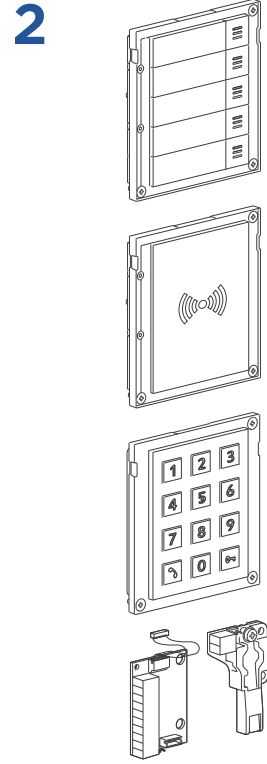
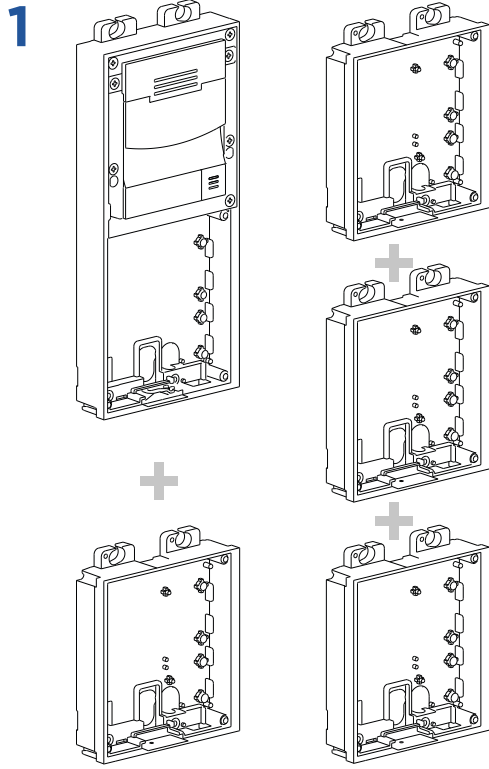

Modularity

MODULES



Main unit with camera and internal LTE*

9155401CB-E
9155401C-E



Infopanel

9155030



5 buttons

9155035



Touch Keypad & RFID Reader 125 kHz, 13.56 MHz, NFC

9155081
9155083 (secure)



Bluetooth & RFID Reader 125 kHz, 13.56 MHz, NFC

9155082
9155082 (secure)



RFID card reader 13.56 MHz 125 kHz

9155033
9155032



RFID card reader 13.56 MHz NFC

9155040
9155042 (secure)



Fingerprint reader

9155045



Keypad

9155031B
9155031



Bluetooth Reader

9155046



Touchscreen

9155036



Touch Keypad

9155047



Induction loop

9155041



Blind Panel

9155039



Wiegand

9155037



Tamper switch

9155038



I/O

9155034

FRAMES



Flush installation 1 module

9155011B
9155011



Flush installation 2 modules

9155012B
9155012



Flush installation 3 modules

9155013B
9155013



Surface installation 1 module

9155021B
9155021



Surface installation 2 modules

9155022B
9155022



Surface installation 3 modules

9155023B
9155023

● Black version
● Nickel version

ACCESSORIES

Boxes

| | |
|----------------------------------|---------|
| Flush-mounting box for 1 module | 9155014 |
| Flush-mounting box for 2 modules | 9155015 |
| Flush-mounting box for 3 modules | 9155016 |

Other

| | |
|----------------------------|---------|
| Extension cable - 1 m long | 9155050 |
| Blind button | 9155051 |
| Nametag foil | 9155052 |

Backplates

| | |
|---------------------------------|---------|
| Backplate - 1 module | 9155061 |
| Backplate - 2 modules | 9155062 |
| Backplate - 3 modules | 9155063 |
| Backplate - 2(w) x 2(h) modules | 9155064 |
| Backplate - 3(w) x 2(h) modules | 9155065 |
| Backplate - 2(w) x 3(h) modules | 9155066 |
| Backplate - 3(w) x 3(h) modules | 9155067 |

External antenna

| | |
|----------------------|---------|
| External LTE antenna | 9155048 |
|----------------------|---------|



Μουρατίδης Χρήστος

Ρόδου 14, 54453 Κάτω Τούμπα, Θεσσαλονίκη Τηλ: 2310 917 677, E-mail: sales@pnt.gr

www.pnt.gr